

THE
RICHARDSON
HUMANE
SOCIETY AND
THE CANINE
CLASSIC

The Canine Classic has become a regular fund raiser for the Richardson Humane Society. As a nonprofit organization, RHS relies solely on your generous donations to rescue, treat, and place deserving animals into forever homes. We hope that this year, our 8th Canine Classic, will be the largest ever. It is our goal to have 100 players. This will only be possible with your help. It costs hundreds of dollars per animal to provide the medical treatment, vaccinations, spay/neuter and training necessary to place animals in deserving homes. The cost can run much higher if heartworm treatment, surgical interventions or other costly conditions exist. Sadly, some animals cannot be saved due to lack of funds and a shortage of homes to foster the pets until adoption. Thank you in advance from the animals yet to be saved and from the Richardson Humane Society for your kind support of this annual event.

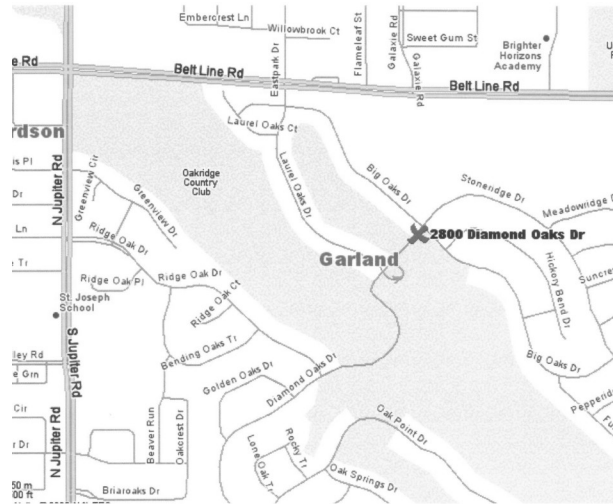

Register online at
www.richardsonhumanesociety.org/golf
Or

Mail Entries to:
P.O. Box 852515
Richardson, Texas 75085
Phone: 972-998-0679
www.richardsonhumanesociety.org



Saving Lives—One Pet at a Time

Saturday, October 3, 2009
Shotgun Start at 1:30 p.m.
Oakridge Country Club
2800 Diamond Oaks Dr.
Garland, Texas
972-530-8008
972-390-7216 (Fax)

Proceeds Benefit
Richardson Humane Society

ALL ENTRIES MUST BE
RECEIVED BY
SEPTEMBER 18, 2009





Who You're Helping

The Richardson Humane Society assists abandoned, abused and neglected dogs and cats. All animals are examined by a veterinarian, treated and fostered in private homes until they are adopted by their forever family. The Richardson Humane Society is funded solely by your donations. All funds raised help pay for food, medical treatment and training. Since its inception, The Richardson Humane Society has rescued and placed into loving homes over 1,600 dogs and cats.

Come join us in helping these deserving animals. Enjoy a great day of golf, food, and prizes.

ALL ENTRIES MUST BE
RECEIVED BY
SEPTEMBER 18, 2009

TOURNAMENT COMMITTEE

Dana Huffman 972-998-0679
Bob Wykes 214-926-7497

HOW TO HELP

You can be a sponsor for this great event. There are several levels of sponsorship to choose from. For more information please call (972)998-0679 or (214) 926-7497. **You can sign up for sponsorships online. Go to www.richardsonhumanesociety.org/golf and click on the SPONSOR link.**

Sponsorship Levels

\$2500.00 Title Sponsor— name entitlement, entry fee for 8 players, 2 tee and green signs, 2 cart sponsorships.

\$1000.00 Platinum Sponsor— entry fee for 4 players, 1 tee and green sign, 2 cart sponsorships.

\$750.00 Gold Sponsor— entry fee for 4 players, 1 tee or green sign, 1 cart sponsorship.

\$500.00 Silver Sponsor— entry fee for 2 players, 1 tee or green sign, 1 cart sponsorship.

\$250.00 Bronze Sponsor— entry fee for 1 player and 1 tee or green sign.

\$100.00 Hole Sponsor/Memorial— signage/photo.

\$25.00 Cart Sponsor/Memorial— signage/photo on cart

\$10.00 Friends and family dining

Name: _____

Company: _____

Address: _____

Phone: _____

Sponsorship Level: _____



SIGN UP!!!! 2 Person Scramble

Entry Fee is \$90.00 per player.
Mulligans (limit 4) - \$5.00 each
Raffle tickets - \$5.00 each
Pay for mulligans and raffle tickets at the tournament.

FEE INCLUDES

Green Fees	Range Balls
Golf Cart	Prize Drawing
Dinner	Goody Bags
Prize Holes	

ENTRY FORM

- Name _____
Address _____
Phone _____
- Name _____
Address _____
Phone _____

Mail Entries to:
P.O. Box 852515
Richardson, Texas 75085
Phone: 972-998-0679
www.richardsonhumanesociety.org
or

Register online at
www.richardsonhumanesociety.org/golf